

NORTH OGDEN BUSINESS CENTER - PHASE 1 FIRST AMENDMENT

AN EXPANDABLE CONDOMINIUM PROJECT

AMENDING UNITS 202 AND 203

North Ogden, Weber County, Utah

A Part of the Northeast Quarter of Section 32.

Township 7 North, Range 1 West, Salt Lake Base and Meridian

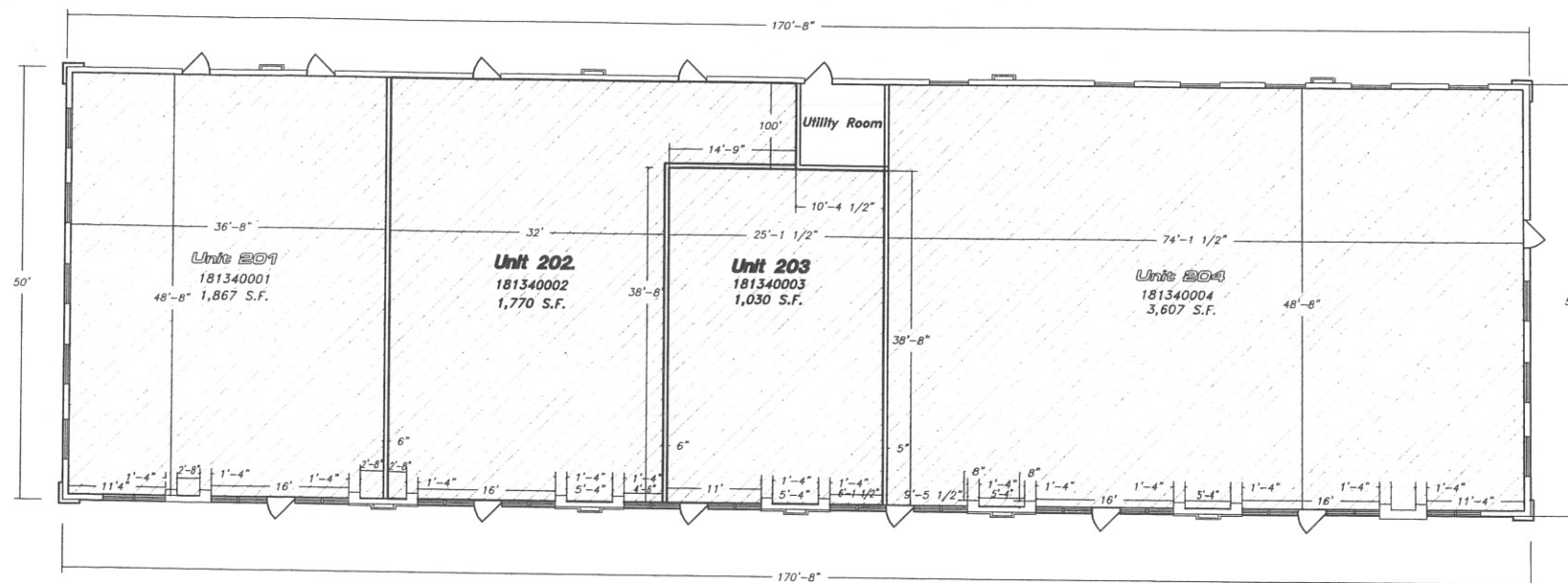

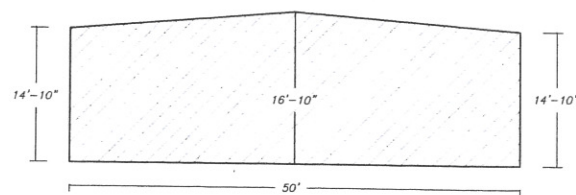

Building #2 Floor Plan

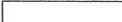

Building #2 Section

LEGEND

-  Common Areas, Facilities and Private Roadways
-  Building Private Area

Finished Floor Elevations
Building #2 Elev. 4366.50

Notes:

1. All Common Areas are Public Utility Easements.
2. All Building Walls are Parallel With, Perpendicular To, or at 45° Angle to Reference Bearing.
3. All Interior Dimensions and Elevations are to Unfinished Surfaces.
4. All Areas are Common Areas and Facilities Except As Otherwise Specifically Designated.
5. All Common Areas and Open Space Areas to be Maintained by Home Owners Association.

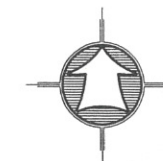

Scale: 1" = 10'
0 10 20
Scale in Feet



HANSEN & ASSOCIATES, INC.
Consulting Engineers and Land Surveyors
538 North Main Street, Brigham, Utah 84302
Visit us at www.haies.net
Brigham City Ogden Logan
(435) 723-3491 (801) 399-4905 (435) 752-8272

COUNTY RECORDER

ENTRY NO. _____ FEE PAID _____
FILED FOR RECORD AND
RECORDED _____, AT
_____ IN BOOK _____ OF OFFICIAL
RECORDS, PAGE _____

COUNTY RECORDER

BY _____ DEPUTY